



## User Manual

### Smart Dual Relay Zigbee

Model: B1DR1ZB

2

## Index

1 Introduction

2 Technical Specifications

3 Installation

4 Device Care and Maintenance

5 Warranty

3

## 1 Introduction

The Zigbee based Smart Dual Relay is a 2-channel, 5A wireless AC power switch device with power monitoring capabilities. It enables remote control of two electrical appliances, each with a 5A capacity, to provide a smart automation experience. This relay allows you to seamlessly connect with the B.One Plus App on your smartphone and conveniently turn on/off connected electrical appliance and monitor their power consumption. It can be installed inside the switchboard and is compatible with the Zigbee-enabled B.One Hub, making it ideal for automating traditional switchboards.

4

## Product Structure

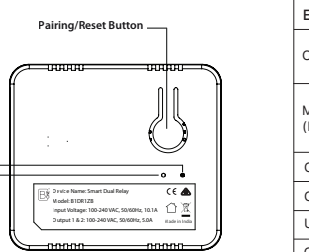

Figure 1: Product Structure

5

## 2 Technical Specifications

Electrical Parameters	
Operating Voltage	100-240 VAC (Single Phase), 50/60 Hz
Maximum Load Rating (Each channel)	5A - Resistive Load 2A - Inductive Load (at 0.4 Power factor)
Over Current Protection	>5.25A soft cutoff (each channel)
Over Voltage Protection	>300 VAC
Under Voltage Protection	<90 VAC
Over Power Protection	>1386 W (each channel)
Over Temperature Cutoff	>80°C

6

## Communications

Protocol	HA Zigbee 3.0
Working Frequency	2400 MHz - 2483.5 MHz
Range	<=50m (Line of Sight Open Area)

## Environmental

Operating Temperature	Operating: 0°C to 50°C Storage: -20°C to 70°C (For indoor use in dry locations only)
Operating Relative Humidity	<90%

## Mechanical

Dimensions	55.3 x 48.5 x 17.6 mm
Colour	White
B.One Plus App Supports	Android 8.0 & above, IOS 15.0 and above

7

## 3 Installation

### 3.1 Requirements

- You will need a smartphone (Android/iOS) with the B.One Plus App installed and your account activated on it.
- The Zigbee-enabled B.One Hub is connected to your home internet router and has been added to your account in the B.One Plus App.

Get B.One Plus App at

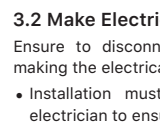

8

For a detailed User Manual scan the QR code below

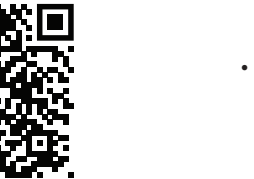

### 3.2 Make Electrical Connections

Ensure to disconnect the power source before making the electrical connections.

- Installation must be done by an experienced electrician to ensure the user safety.

9

- While installing device, ensure that B.One logo must be front-faced. This is required for proper communication with the Zigbee-enabled B.One Hub.

- While making the electrical connection, lugs must be connected using a crimping tool. If the lugs are not connected properly, then it may lead to short circuit and damage the device.

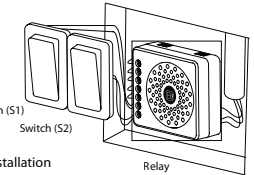

Figure 2: Installation

10

Refer to the figure below to connect the Smart Relay to the external switch:

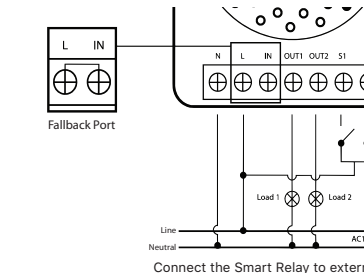

Figure 2: Electrical Connections

11

## 3.3 LED Indicators

LED	Status	Description
Green 1	Solid	L1 ON, Paired
Green 2	Solid	L2 ON, Paired
Green 1	Off	L1 Off, Paired
Green 2	Off	L2 Off, Paired
Green 1, 2	Fast Blink (1 sec delay)	Pairing Mode
Red	Slow Blink (2 sec delay)	Not Paired with controller
Green 1	Blink (5 times in 1.5 sec)	Factory Reset

12

## 3.4 Addition of the Device

- Launch the B.One Plus App. From the Home screen, navigate to **Devices > Tap on the (+) button > Switches and Controls > Zigbee Switches and Controls > Dual In-wall Relay** and follow the device pairing instructions.

## 3.5 Device Pairing

- After powering ON, Smart Dual Relay goes into auto addition mode for the next 5 minutes and it will be added into the Zigbee-enabled B.One Hub. If the Relay is not added to the network, then it can be paired using any one of the following options:

- Using Pairing/Reset Button:** Press the button 5 times within 8 seconds to put device into pairing

13

- Relay LEDs at the back turns solid Green (if external switch is ON) or no LED (if external switch is OFF) after successful pairing.

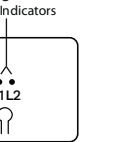
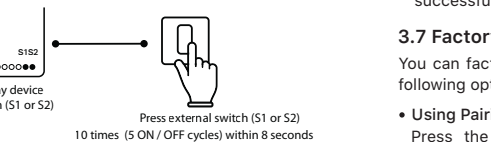

Figure 4: Device Pairing

- **Using External Switch (S1/S2):** Turn ON/OFF the external switch (S1/S2) 10 times (5 ON/OFF cycles) within 8 seconds.
- After successfully joining the network, both the LEDs would be turned ON/OFF (Depends on the

14

state of the external switch i.e. ON - Green and OFF - LED goes OFF).



### 3.6 Deletion of the Device

To delete the device or to remove it from the Zigbee-enabled B.One Hub, follow the steps:

1. On the B.One Plus App, select the Devices screen and tap on Edit. Select (-) icon to delete the device.

15

2. Tap on **Delete** to confirm the device deletion. Screen displays confirmation message when it is successfully removed from the Zigbee network.

### 3.7 Factory Reset

You can factory reset the device using one of the following options:

- **Using Pairing/Reset Button:** Press the pairing/Reset button 5 times within 8 seconds to factory reset the device.

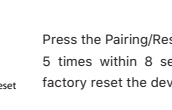

Press the Pairing/Reset button 5 times within 8 seconds to factory reset the device.

16

- **Using External Switch (S1/S2):** Turn ON/OFF the external switch (S1/S2) 10 times (5 ON/OFF cycles) within 8 seconds.

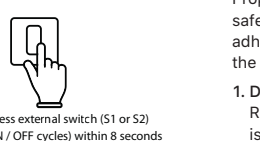

- Once factory reset is done, the connected load blinks twice and the device goes into pairing mode.

17

## 4 Device care and Maintenance

### Correct Disposal:

Proper disposal of the Dual Relay device is vital for safety and environmental considerations. Please adhere to the following guidelines when disposing of the device:

1. **Do not dispose of the device into fire:** The Dual Relay device contains combustible components. It is crucial to never dispose of the device by burning it or exposing it to fire. This can lead to hazardous situations and environmental pollution.
2. **Do not dispose of the device with regular waste:** The Dual Relay device should not be discarded with regular household or municipal waste. Improper disposal may result in the device ending up in land-

18

-fills or being incinerated, posing risks to the environment and human health.

### Proper Disposal Options:

To ensure the correct and responsible disposal of the Dual Relay device, consider the following options:

1. **Electronic waste recycling:** Look for local electronic waste recycling facilities or programs in your area. These facilities specialize in the proper handling and recycling of electronic devices. Contact your local recycling center or municipality for information on drop-off points or collection events for electronic waste.
2. **Manufacturer or retailer programs:** Check if the manufacturer or retailer of the Dual Relay device has a take-back program or recycling initiative in

19

place. Many companies offer recycling services for their products to promote responsible disposal. Visit their official website or contact their customer support for more information on how to return the device for proper recycling.

### Exclusions:

This warranty does not apply to: a) damage caused by failure to follow the instructions(as explained in the user manual) relating to the product's use or the installation of components b) damage caused by accident, abuse, misuse, transport, neglect, fire, floods, earthquake or other external causes; c) damage caused by service performed by anyone who is not an authorized representative of Blaze Automation; d) accessories used in conjunction with a covered product; e) the Product or part that has been modified to alter functionality or capability; f) items

### 5 Warranty

Blaze Automation warrants its products against defects in materials and/or workmanship under normal use for a period of ONE (1) YEAR from the date of purchase by the original purchaser ("Warrant

20

any replacement item becomes your property and the replaced product or part becomes a property of Blaze Automation.

### Obtaining Service:

To obtain warranty service, speak with your point of contact at Blaze or with the authorized distributor from your country of purchase. Please be prepared to describe the product that needs service and the nature of the problem. A purchase receipt is required. The product must be insured, and shipped freight prepaid and securely packaged. You must contact Blaze for a Return Material Authorization Number ("RMA Number") before shipping any product, and include the RMA Number, a copy of your purchase receipt and a description of the problem you are

experiencing with the product. Any claim under this Limited Warranty must be submitted to Blaze Automation before the end of warranty period.

21

intended to be periodically replaced by the purchaser during the normal life of the Product, including, without limitation, batteries, bulbs or cables; g) the Product that is used commercially or for a commercial purpose, in each case as determined by Blaze Automation.

### Obtaining Service:

To obtain warranty service, speak with your point of contact at Blaze or with the authorized distributor from your country of purchase. Please be prepared to describe the product that needs service and the nature of the problem. A purchase receipt is required. The product must be insured, and shipped freight prepaid and securely packaged. You must contact Blaze for a Return Material Authorization Number ("RMA Number") before shipping any product, and include the RMA Number, a copy of your purchase receipt and a description of the problem you are

### Obtaining Service:

To obtain warranty service, speak with your point of contact at Blaze or with the authorized distributor from your country of purchase. Please be prepared to describe the product that needs service and the nature of the problem. A purchase receipt is required. The product must be insured, and shipped freight prepaid and securely packaged. You must contact Blaze for a Return Material Authorization Number ("RMA Number") before shipping any product, and include the RMA Number, a copy of your purchase receipt and a description of the problem you are

22

intended to be periodically replaced by the purchaser during the normal life of the Product, including, without limitation, batteries, bulbs or cables; g) the Product that is used commercially or for a commercial purpose, in each case as determined by Blaze Automation.

### Obtaining Service:

To obtain warranty service, speak with your point of contact at Blaze or with the authorized distributor from your country of purchase. Please be prepared to describe the product that needs service and the nature of the problem. A purchase receipt is required. The product must be insured, and shipped freight prepaid and securely packaged. You must contact Blaze for a Return Material Authorization Number ("RMA Number") before shipping any product, and include the RMA Number, a copy of your purchase receipt and a description of the problem you are

### Obtaining Service:

To obtain warranty service, speak with your point of contact at Blaze or with the authorized distributor from your country of purchase. Please be prepared to describe the product that needs service and the nature of the problem. A purchase receipt is required. The product must be insured, and shipped freight prepaid and securely packaged. You must contact Blaze for a Return Material Authorization Number ("RMA Number") before shipping any product, and include the RMA Number, a copy of your purchase receipt and a description of the problem you are

23

THIS WARRANTY, EVEN IF COMPANY HAS BEEN ADVISED OF THE POSSIBILITY OF SUCH DAMAGES.

### Obtaining Service:

To obtain warranty service, speak with your point of contact at Blaze or with the authorized distributor from your country of purchase. Please be prepared to describe the product that needs service and the nature of the problem. A purchase receipt is required. The product must be insured, and shipped freight prepaid and securely packaged. You must contact Blaze for a Return Material Authorization Number ("RMA Number") before shipping any product, and include the RMA Number, a copy of your purchase receipt and a description of the problem you are

### Obtaining Service:

To obtain warranty service, speak with your point of contact at Blaze or with the authorized distributor from your country of purchase. Please be prepared to describe the product that needs service and the nature of the problem. A purchase receipt is required. The product must be insured, and shipped freight prepaid and securely packaged. You must contact Blaze for a Return Material Authorization Number ("RMA Number") before shipping any product, and include the RMA Number, a copy of your purchase receipt and a description of the problem you are

### Obtaining Service:

To obtain warranty service, speak with your point of contact at Blaze or with the authorized distributor from your country of purchase. Please be prepared to describe the product that needs service and the nature of the problem. A purchase receipt is required. The product must be insured, and shipped freight prepaid and securely packaged. You must contact Blaze for a Return Material Authorization Number ("RMA Number") before shipping any product, and include the RMA Number, a copy of your purchase receipt and a description of the problem you are

24

To exercise your rights under this warranty, please follow the instructions above under the heading "Obtaining Service" or contact Blaze Automation at Blaze Automation Services Private Limited, Q2, 10th floor, Cyber Towers, Hitech-city, Hyderabad, Telangana - 500081, India.

### Obtaining Service:

To obtain warranty service, speak with your point of contact at Blaze or with the authorized distributor from your country of purchase. Please be prepared to describe the product that needs service and the nature of the problem. A purchase receipt is required. The product must be insured, and shipped freight prepaid and securely packaged. You must contact Blaze for a Return Material Authorization Number ("RMA Number") before shipping any product, and include the RMA Number, a copy of your purchase receipt and a description of the problem you are

### Obtaining Service:

To obtain warranty service, speak with your point of contact at Blaze or with the authorized distributor from your country of purchase. Please be prepared to describe the product that needs service and the nature of the problem. A purchase receipt is required. The product must be insured, and shipped freight prepaid and securely packaged. You must contact Blaze for a Return Material Authorization Number ("RMA Number") before shipping any product, and include the RMA Number, a copy of your purchase receipt and a description of the problem you are

### Obtaining Service:

To obtain warranty service, speak with your point of contact at Blaze or with the authorized distributor from your country of purchase. Please be prepared to describe the product that needs service and the nature of the problem. A purchase receipt is required. The product must be insured, and shipped freight prepaid and securely packaged. You must contact Blaze for a Return Material Authorization Number ("RMA Number") before shipping any product, and include the RMA Number, a copy of your purchase receipt and a description of the problem you are